

Technology Accelerator Space

350 HILLS STREET, RICHLAND, WA

OWNED AND OPERATED BY:



Applied Process Engineering Laboratory (APEL)

APEL is the regional launch site for innovative entrepreneurs, start-up businesses and companies developing leading-edge technologies.

FACILITY BENEFITS

- 96,000 sq. ft. of commercially zoned laboratory, high bay and office space, including conference rooms and a lunch room
- Space currently available includes:
 - Office space ranging from 118-280 sq. ft.
 - High bay space
 - Wet labs ranging from 600-900 sq. ft.
 - Electrical/dry labs ranging from 400-600 sq. ft.
- Electronic card-key controlled security access
- CAT 5 cable and telephone to each laboratory, office and conference room
- Point of presence for Voice Over Internet Protocol (VOIP) Local Area Provider
- Facility meets American Disabilities Act (ADA) standards
- Parking lot with 126 standard parking spaces and four ADA spaces

LOCATION/AMENITIES

- Located in Tri-Cities Research District near Pacific Northwest National Laboratory and Washington State University
- Adjacent to public transportation route
- Banking, restaurants, recreational river and walk/bicycle trail within walking distance

INFORMATION CONTACT

Angel Rains 509.377.4491
adrains@energy-northwest.com



96,000 SQUARE FEET OF COMMERCIALLY ZONED SPACE

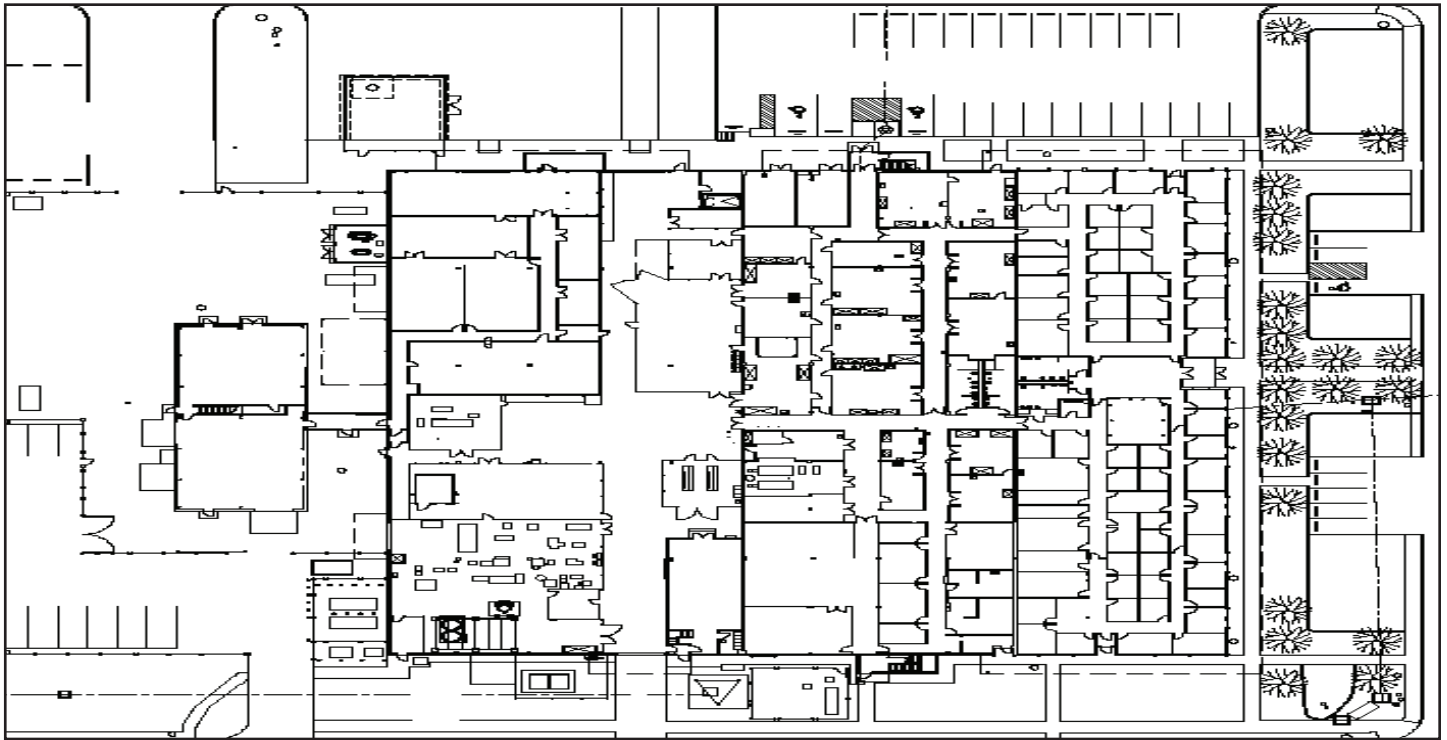

- ✓ High bay space
- ✓ Laboratory space
- ✓ Office space



INFORMATION
CONTACT

Angel Rains 509.377.4491
adrains@energy-northwest.com